

参数信息:

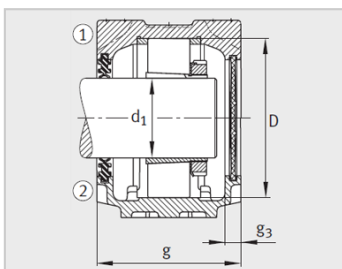
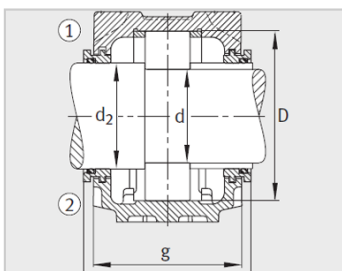
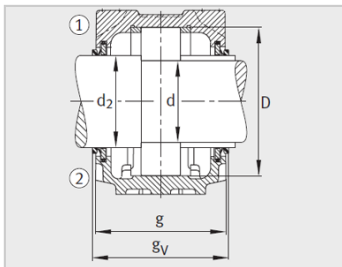
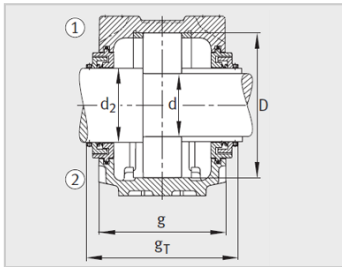

Modell :

Lagersitz :	SNV250-L
Lager :	22228-E1
Sicherungsmutter :	KM28
Unterlegscheibe anhalten :	MB28
Stop Ring2 St ü ck :	FRM250/15
LippenDichtring :	DH228
Labyrinthdichtungsring mit O-Ring :	TSV228
Filzdichtung :	FSV228
V-f ö rmiger Ring :	DHV228
Lagerdeckel :	DKV250
Masse m Lagersitz kg :	38

Gr ö ß e :

d :	140
a :	500
g :	200
h :	304
d :	155
b :	150
c :	50
D :	250
g :	218.3
g :	211.5
g :	18
h :	150
m :	420
u :	35
v :	42
smm :	M30
sinch :	1 1/4

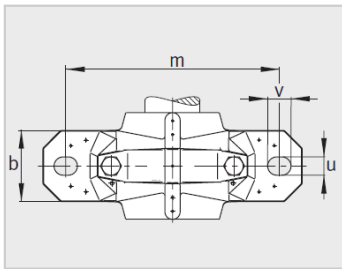
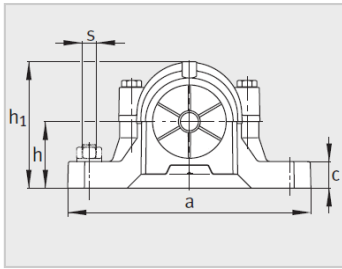

: