

参数信息:

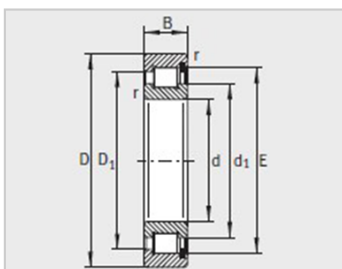
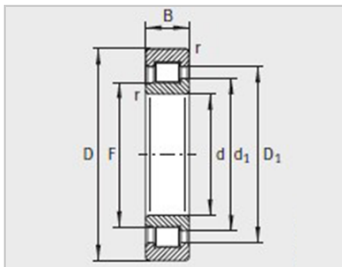
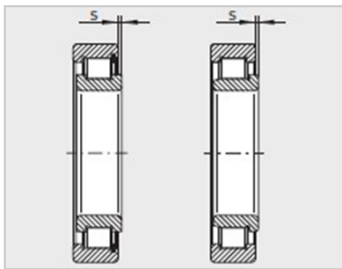

Modell :	SL182934
Masse/m kg :	4.3

Gr ö ß emm :

d :	170
D :	230
B :	36
r min :	2
s :	2.5

Einbaugr ö ß emm :

F :	-
d :	190.6
D :	211.3
E :	218.45

NennlastN :

Dynamische Last :	365000
Statische Last :	540000
Endlast der Erm ü dungCur/N :	80000
Extreme Geschwindigk eitnG/min-1 :	1610
Referenzgeschwindigkei tnB/min-1 :	1190

: